

Fuser assembly

CAUTION

The fuser assembly can be hot. Use caution when removing it.

Note

If an optional output accessory is installed, remove it. See page 171.

If a duplexer is installed, remove it. See page 146.

- 1 Lift the left door handle, and then open the left door.
- 2 Rotate the two blue locking tabs (callout 1) toward each other and downward to release them.

Note

Do not release the T-shaped envelope levers (callout 2).

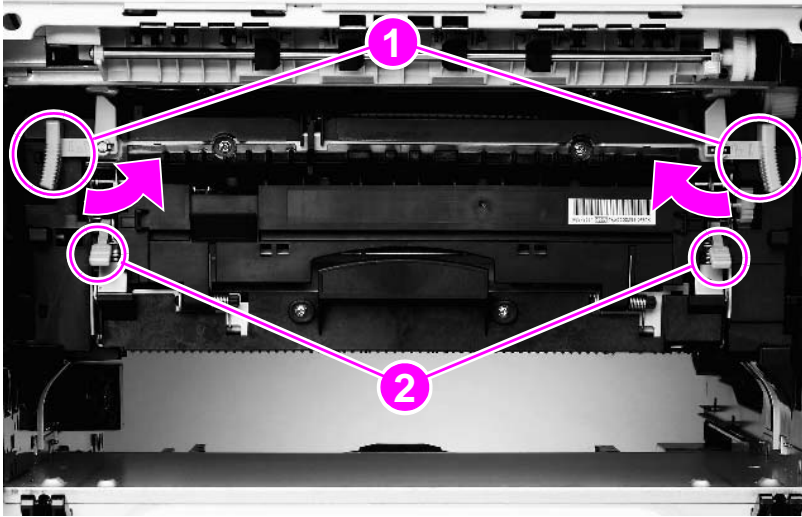

Figure 89. Removing the fuser assembly (1 of 2)

- 3 Pull the center handle (callout 3) to rotate the fuser assembly upward slightly, and then slide the fuser assembly outward until it locks.

WARNING!

The fuser assembly is heavy. Grasp the blue handle firmly before attempting to lift the fuser assembly.

- 4 Firmly grasp the blue handle (callout 4), and lift the fuser assembly out of the printer.

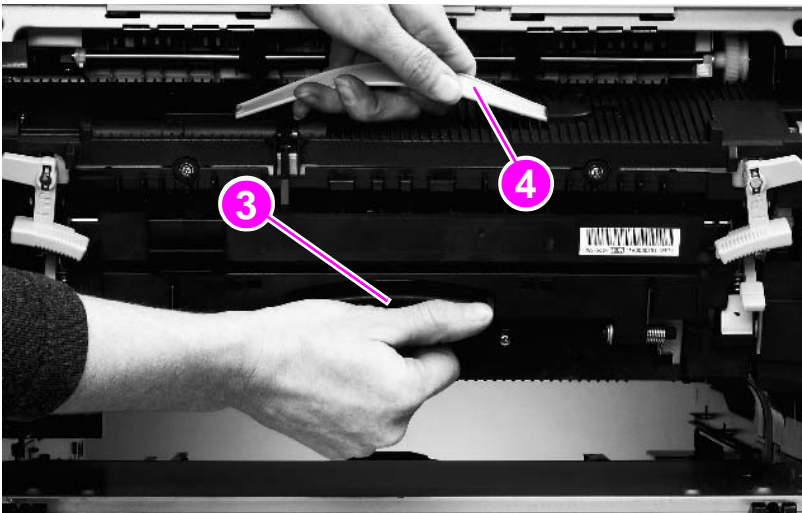

Figure 90. Removing the fuser assembly (2 of 2)

Transfer roller assembly

WARNING!

Do not touch the black transfer roller, because skin oils can damage the roller.

- 1 Open the front cover.
- 2 Unlock the print cartridge by rotating the large green lever (callout 1) downward.
- 3 Pinch the blue tab (callout 2), and slowly pull the transfer roller assembly out of the printer.
- 4 Lift the assembly upward to release the catch on the underside, and remove the assembly from the printer.

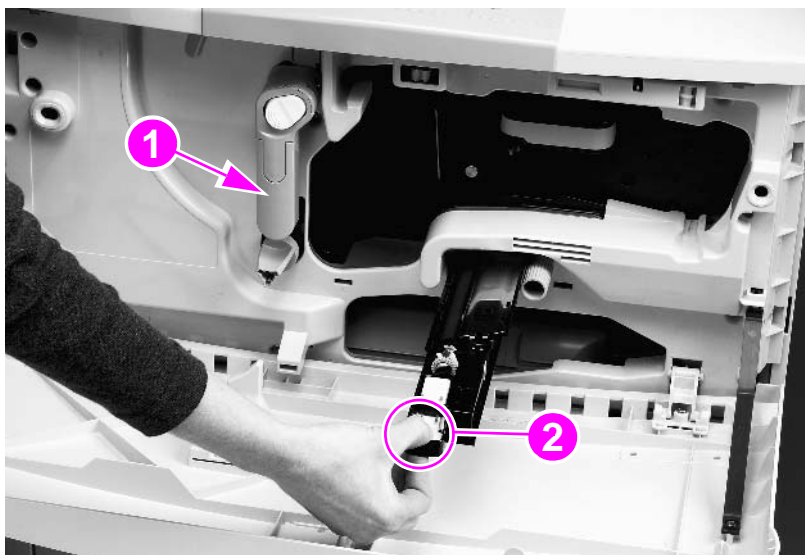

Figure 72. Removing the transfer roller assembly

Tray 2 or tray 3 (interchangeable)

- 1 Slide the tray open until it stops.
- 2 Grasp the sides of the tray.
- 3 Lift the tray up and remove it.



Figure 73. Removing tray 2 or tray 3

Rollers (pickup, feed, or separation)

CAUTION

Do not remove the black spacer from behind the separation roller. If the black spacer comes off, return it to the shaft metal edge first.

- 1 Remove tray 2 or tray 3 (page 136).
- 2 Locate the appropriate roller on the upper right side of the tray cavity. The pickup roller (callout 1) is a type 1 roller. The feed roller (callout 2) and the separation roller (callout 3) are type 2 rollers.
- 3 Pinch the tab on the end of each roller to release it.
- 4 Slide the roller off the shaft.

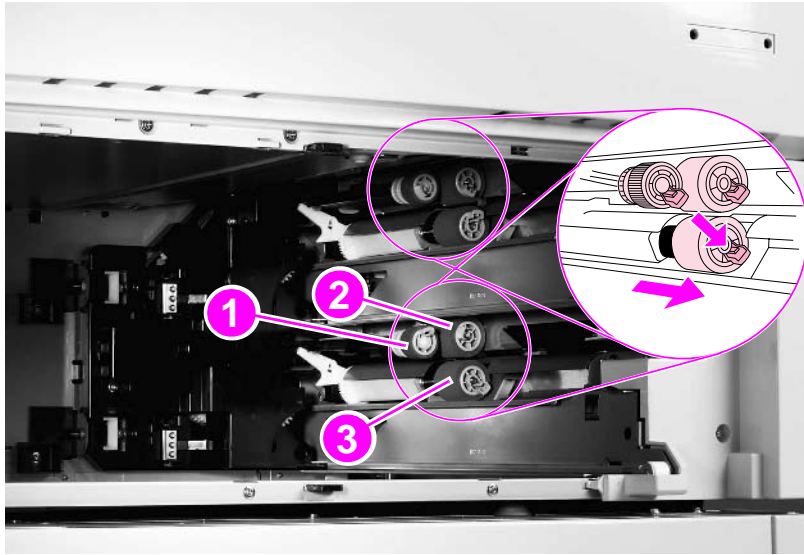

Figure 74. Removing the rollers